



The Victoria Hotel

Function Pack





Function Rooms

The Victoria Hotel has two function rooms available. Each room has its own distinct ambiance and style. The function rooms are perfect for most occasions from small business meetings, large conferences to any special events.

The Victoria Room

Full Day Hire \$300.00 (excluding GST).

Located on the first floor of the hotel, wheelchair access provided. Access available direct from St Andrew Street. Approximately 9m (width) x 19m (length). Fully stocked bar located in the room as well as male and female toilets.

Able to seat up to 80 banquet style, 75 theatre style, 30 U-shape, 50 classroom style, 42 boardroom style and 100+ standing (please refer to next section for Layout Descriptions).

Includes table setting, white board, pens, water, all day tea and coffee.

Well Manor Restaurant

Full Day Hire \$250.00 (excluding GST).

Located on the ground floor of the hotel, approximately 12m (width) x 12m (length). Fully stocked bar located in the room as well as male and female toilets.

Able to seat 60 banquet style, 75 theatre style, 30 U-shape & classroom style, 40 boardroom style and 80+ standing.

Includes table setting, white board, pens, water, all day tea and coffee.



Layout Descriptions

This page shows the layout descriptions for the Banquet Squares' layouts for 6 and 10 people per table. (Please note the floor plan example used here is **The Victoria Room** which is located on the first floor. Room dimension is approximately 9m (width) x 19m (length)).

Banquet Squares

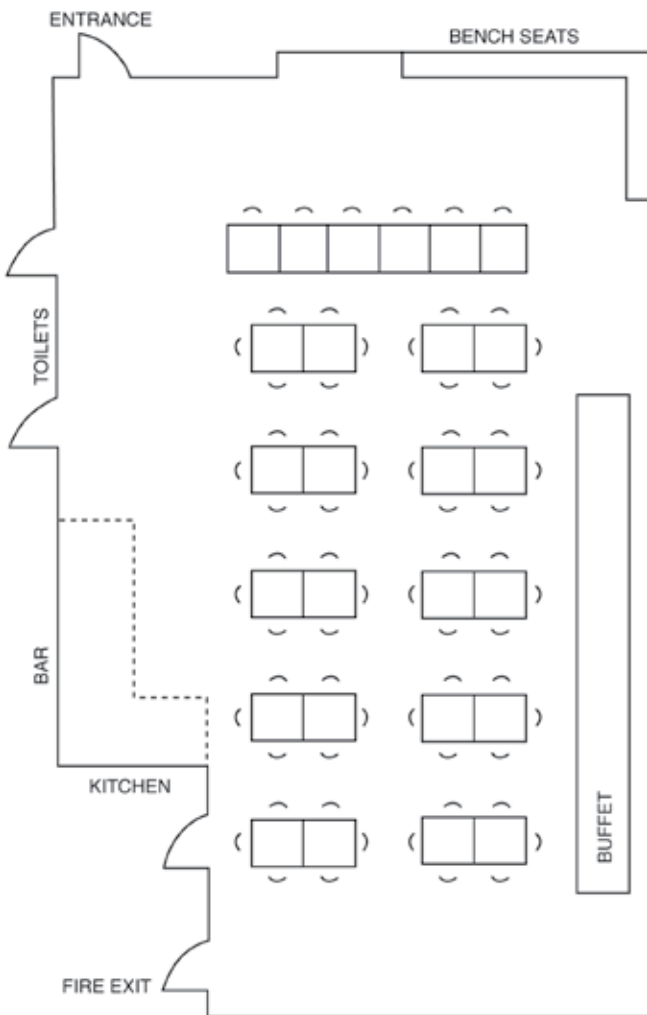

Tables of 6:
66 pax (6 on head table)
72 pax (no head table)

Banquet Squares

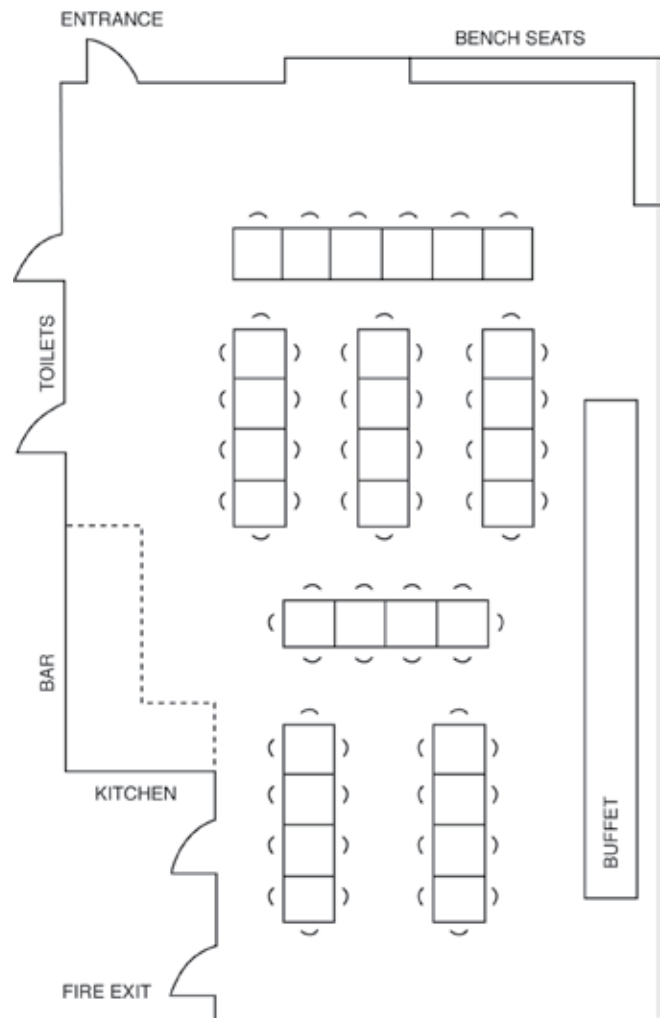

Tables of 10:
60 pax (6 on head table)



Layout Descriptions

This page shows the layout descriptions for the Banquet Squares' layout for 12 people per table, and the Boardroom style. (Please note the floor plan example used here is **The Victoria Room**.)

Banquet Squares

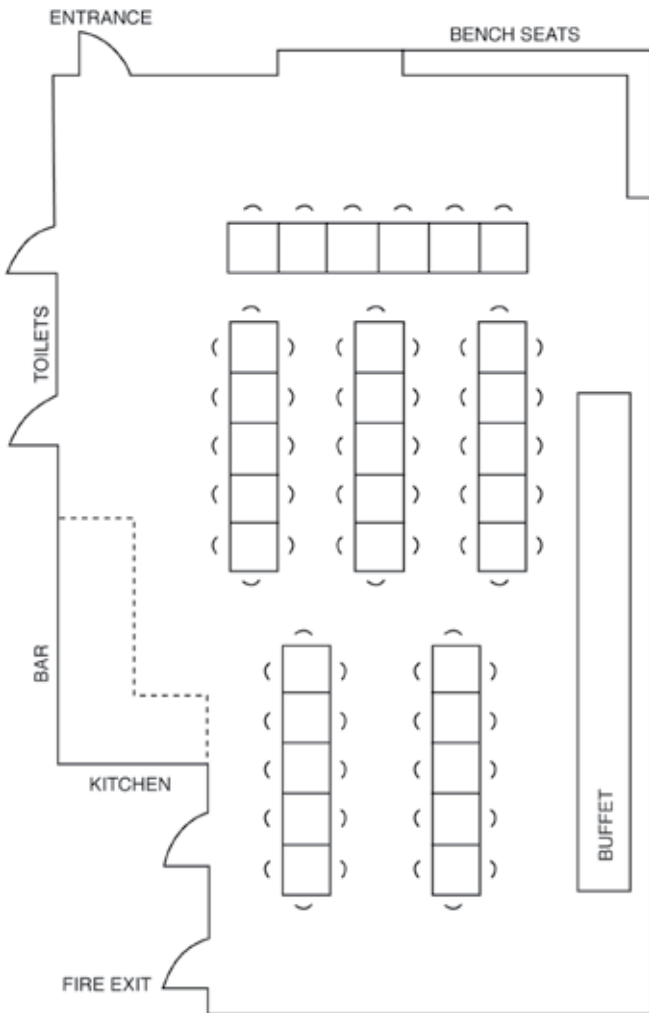

Tables of 12:
60 pax (6 on head table)

Boardroom

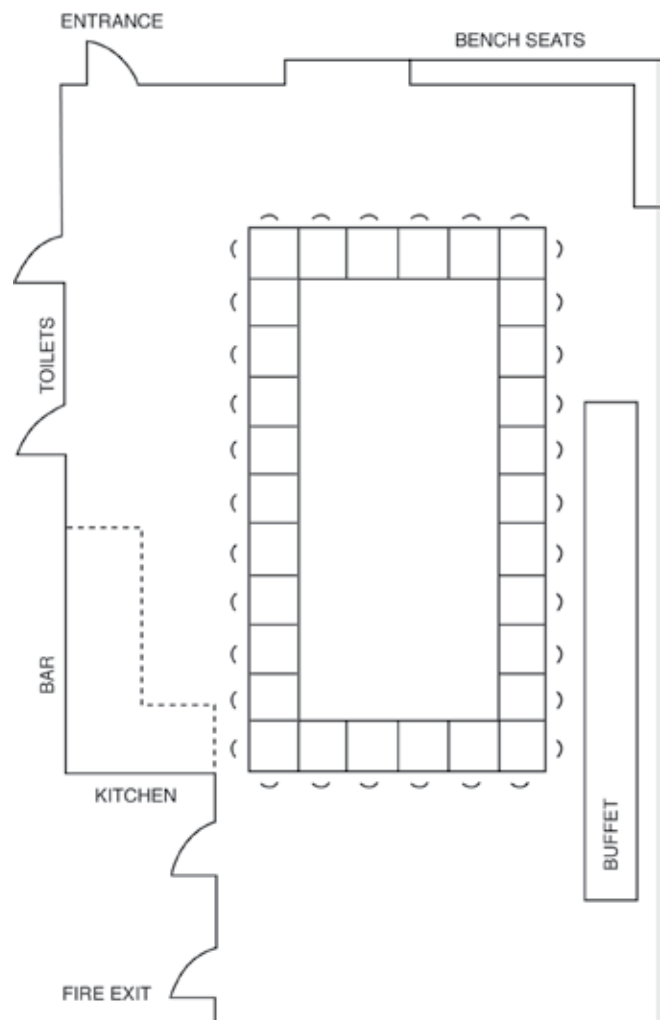

Tables of 12:
60 pax (6 on head table)



Layout Descriptions

This page shows the layout descriptions for the Classroom and U-Shape styles. (Please note the floor plan example used here is **The Victoria Room.**)

Classroom

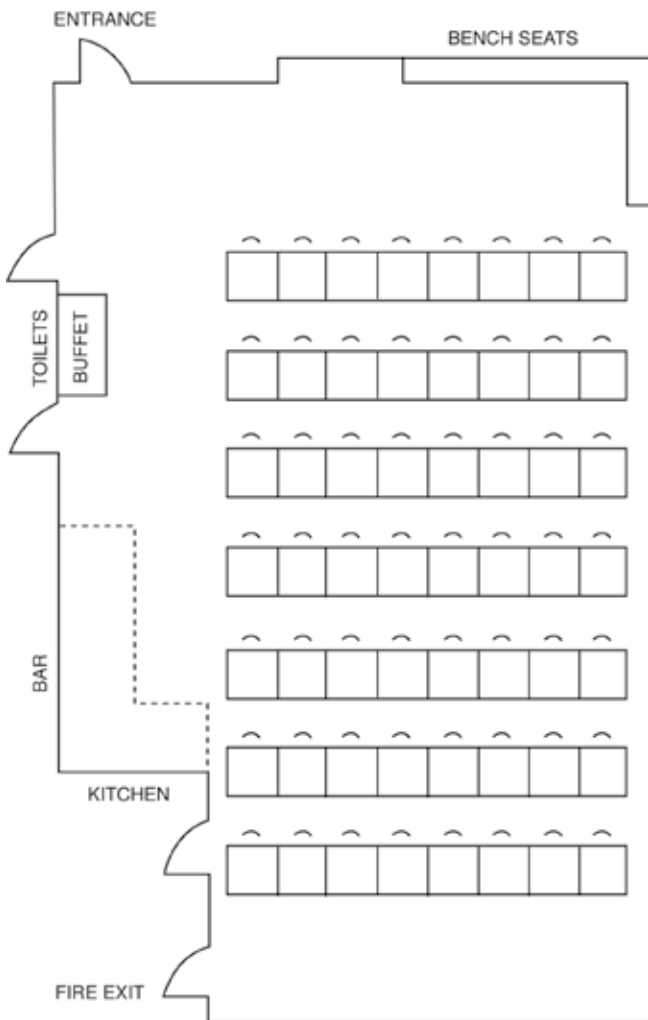

Tables of 8:
50 pax with small buffet
(Suitable for platters)

U-Shape

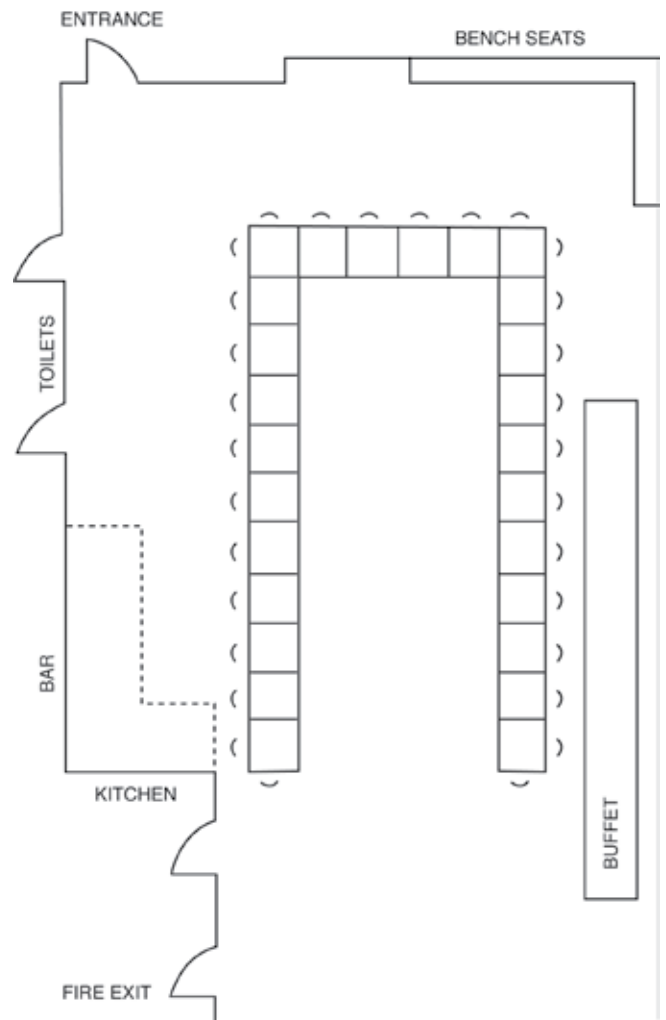

30 pax (6 on head table)
(With full buffet)



Well Manor Restaurant Floor Plan

The restaurant is located on the ground floor. Room dimension is approximately 12m (width) x 12m (length). Most of the seating arrangements in the previous Layout Descriptions can be applied to the restaurant as well.

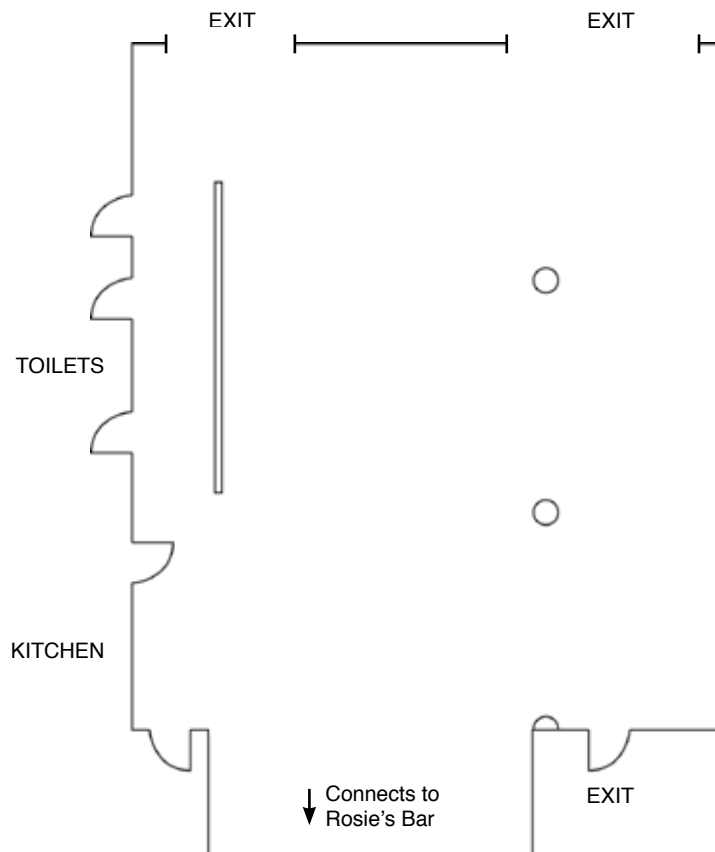

Top: Well Manor Restaurant floor plan drawing. Below: U-shape table arrangement sample photo.





Equipment Hire

The function rooms already come with some basic room set up (please refer to the second page). Additional item hire costs are listed on this page. If you require any other items not listed on this page, please contact us for more details.



Data Projector & Screen.....\$240.00 per day (excluding GST)

Microphone & Speaker.....\$30.00 per day (excluding GST)

Over Head Projector.....P.O.A

Flip Chart.....\$10.00 per day (excluding GST)

DVD Player.....\$20.00 per day (excluding GST)

50" Plasma TV.....\$90.00 per day (excluding GST)

Function Catering

All menu items can be discussed with the Chef, we are happy to design a menu with you to suit your needs.



Breakfast Buffet

\$20.00 / person (excluding GST)

Homemade muesli, Cereal, Toast, Scrambled Eggs, Bacon, Tomato, Sausage, Hash Brown, Sautéed Mushrooms and a Selection of Simply Squeezed Juices, Tea and Coffee.

Morning Tea

\$4.35 / person (excluding GST)

Homemade Scones & Muffins, Tea and Coffee and a Selection of Simply Squeezed Juices.

Lunch Buffet

\$18.00 / person (excluding GST)

Choice of two of the following:

- A) Beef Hot Pot, Vegetable Lasagne or
- B) Chicken Currie and Vegetable Currie

Selection of Sandwiches, Wraps and Salads.

Afternoon Tea

\$4.35 / person (excluding GST)

Homemade Short Bread and Chocolate Chip Cookies, Tea and Coffee and a Selection of Simply Squeezed Juices.

Finger Food

\$15.00—\$25.00 / person (excluding GST)

A selection of 4 to 8 types of finger food. Hot and cold finger food available.



Function Catering

All menu items can be discussed with the Chef, we are happy to design a menu with you to suit your needs.

Dinner Buffet

\$45.00 / person (excluding GST)

Meats (Choice of two)

(One piece extra meat: \$10 more on top of set price)

Lamb, Ham, Beef, Turkey or Chicken

Salads (Choice of four)

Waldorf Salad, Mixed Leaf, Potato Salad, Coleslaw, Mixed Bean Salad, One Dressed Salmon Whole

Vegetables (Choice of three)

Broccoli, Cauliflower Cheese, Carrots, Roast Pumpkin, Roast Butternut, Beans

Potatos (Choice of two)

Mash Potatoes, New Potatoes, Roast Potatoes

Desserts (Choice of four)

Banoffee, Portvillar Rolls, Pavalova, Trimsurc, Chocolate Mud Cake, Lemon Meringue Pie, Fresh Fruit Salad

Tea, Coffee and Shortbread included



Function Catering

All menu items can be discussed with the Chef, we are happy to design a menu with you to suit your needs.



Engagement Dinner—A sample of our Four Course Menu

\$55.00 / person (excluding GST)

Soup

Delicious Beetroot and Cinnamon Soup
Served with hot bread

Entrée

- A) Garlic Prawns
Pan fried garlic prawns resting on a bed of lettuce with delectable smoked salmon
- B) Mussel and Potato Broth
Mussels, potato and garlic served with fish broth with a pleasant hit of cream and served with fresh bread

Main

- A) Braised Pork Belly
Heavenly slow cooked pork belly with blueberry clots, rosti potato and red wine jus
- B) Scallop Mornay
Served with summer greens and new potatoes

Dessert

- A) Creme Brulee
Divine cream brulee served with berry compot and short bread
- B) Trifle
Luscious raspberry vanilla trifle served with vanilla ice cream and wrapped in oats

